

PROJECT
ABERDEEN VALLEY FAIR
ABERDEEN NSW 2336

CLIENT
ENEF INVESTMENTS PTY LTD

LEGEND

- EXISTING CONTOUR
- EXISTING SPOTLEVEL
- SEDIMENT CONTROL FENCE, REFER TO DRAWING 13362-DA05 FOR DETAILS
- STABILISED SITE ACCESS, REFER TO DRAWING 13362-DA05 FOR DETAILS
- SANDBAG SEDIMENT TRAP, REFER TO DRAWING 13362-DA05 FOR DETAILS
- TEMPORARY STOCKPILE, REFER TO DRAWING 13362-DA05 FOR DETAILS
- EXISTING ELECTRICITY LINE
- EXISTING SEWER LINE
- EXISTING TELSTRA LINE
- EXISTING WATER LINE
- BOUNDARY LINE
- EXISTING EASEMENT LINE
- EXISTING FENCE

NOTES

THE ARRANGEMENT OF SEDIMENT AND EROSION CONTROL MEASURES SHOWN ARE INDICATIVE ONLY AND RELATE TO A PARTICULAR STAGE OF THE CONSTRUCTION WORKS. IT SHALL BE THE CONTRACTOR'S RESPONSIBILITY TO DESIGN, CONSTRUCT AND MAINTAIN ANY ADDITIONAL MEASURES THAT MAY BE REQUIRED FOR THE CONTRACTOR'S CONSTRUCTION METHODOLOGIES, IN ORDER TO MEET ALL CONDITIONS AND REQUIREMENTS IMPOSED BY ANY STATUTORY AUTHORITY.

THE POSITION OF ALL EXISTING SERVICES SHOWN SHOULD BE REGARDED AS APPROXIMATE AND NOT NECESSARILY COMPREHENSIVE. IT IS THE CONTRACTOR'S RESPONSIBILITY TO DETERMINE THE EXACT LOCATIONS OF ALL SERVICES WHETHER SHOWN ON THE DRAWING OR NOT AND INFORM ALL RELEVANT AUTHORITIES PRIOR TO ANY EXCAVATION.

CONTRACTOR TO VERIFY SETOUT BEFORE COMMENCING EARTHWORKS. REFER ANY DISCREPANCIES TO ENGINEER.

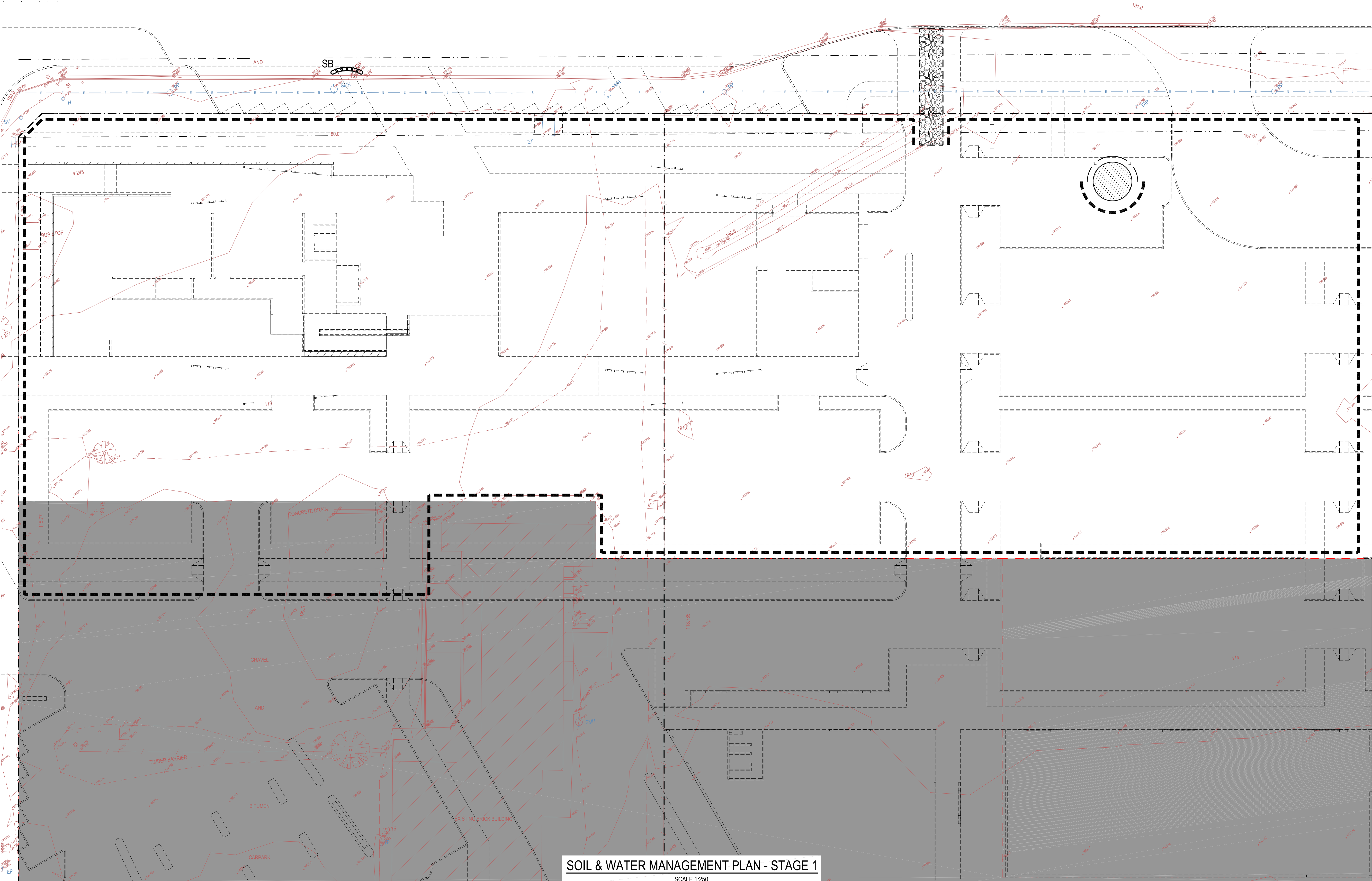

SOIL & WATER MANAGEMENT PLAN - STAGE 1

SCALE 1:250

NOT FOR CONSTRUCTION

B	11/12/18	RE-ISSUED FOR DA APPROVAL	A.V.	M.W.
A	20/06/17	ISSUED FOR DA APPROVAL	A.V.	A.T.
REV	DATE	DRAWING STATUS	DRN	APP
TITLE				
SOIL & WATER MANAGEMENT PLAN STAGE 1			SHEET SIZE A1	
DRAWING STATUS DRAFT COPY			SCALE 1:250	
DRAWN M.Bector	DESIGNED A.Thompson	APPROVED M.Watson	PROJECT No. 13662	
DRAWING No. DA01			REVISION B	

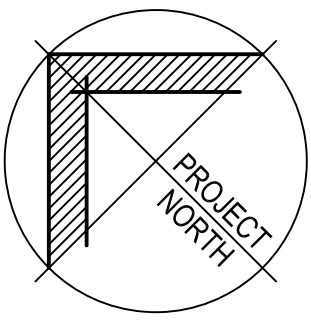

PROJECT
ABERDEEN VALLEY FAIR
ABERDEEN NSW 2336

CLIENT
ENEF INVESTMENTS PTY LTD

LEGEND

- EXISTING CONTOUR
- EXISTING SPOTLEVEL
- SEDIMENT CONTROL FENCE, REFER TO DRAWING 13362-DA05 FOR DETAILS
- STABILISED SITE ACCESS, REFER TO DRAWING 13362-DA05 FOR DETAILS
- SANDBAG SEDIMENT TRAP, REFER TO DRAWING 13362-DA05 FOR DETAILS
- TEMPORARY STOCKPILE, REFER TO DRAWING 13362-DA05 FOR DETAILS
- EXISTING ELECTRICITY LINE
- EXISTING SEWER LINE
- EXISTING TELSTRA LINE
- EXISTING WATER LINE
- BOUNDARY LINE
- EXISTING EASEMENT LINE
- EXISTING FENCE

NOTES

THE ARRANGEMENT OF SEDIMENT AND EROSION CONTROL MEASURES SHOWN ARE INDICATIVE ONLY AND RELATE TO A PARTICULAR STAGE OF THE CONSTRUCTION WORKS. IT SHALL BE THE CONTRACTOR'S RESPONSIBILITY TO DESIGN, CONSTRUCT AND MAINTAIN ANY ADDITIONAL MEASURES THAT MAY BE REQUIRED FOR THE CONTRACTOR'S CONSTRUCTION METHODOLOGIES, IN ORDER TO MEET ALL CONDITIONS AND REQUIREMENTS IMPOSED BY ANY STATUTORY AUTHORITY.

THE POSITION OF ALL EXISTING SERVICES SHOWN SHOULD BE REGARDED AS APPROXIMATE AND NOT NECESSARILY COMPREHENSIVE. IT IS THE CONTRACTOR'S RESPONSIBILITY TO DETERMINE THE EXACT LOCATIONS OF ALL SERVICES WHETHER SHOWN ON THE DRAWING OR NOT AND INFORM ALL RELEVANT AUTHORITIES PRIOR TO ANY EXCAVATION.

CONTRACTOR TO VERIFY SETOUT BEFORE COMMENCING EARTHWORKS. REFER ANY DISCREPANCIES TO ENGINEER.

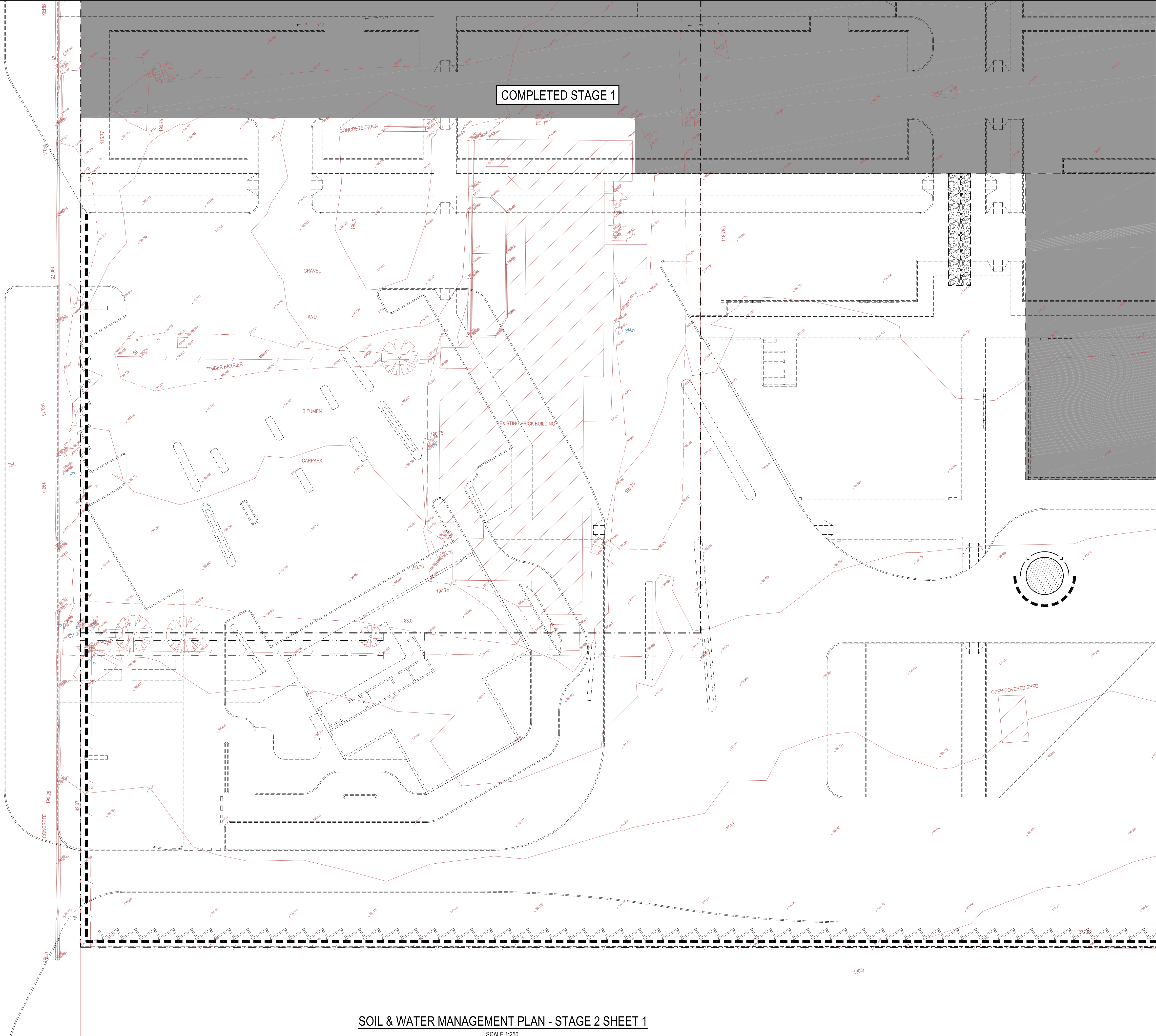

SOIL & WATER MANAGEMENT PLAN - STAGE 2 SHEET 1
SCALE 1:250

B	11/12/18	RE-ISSUED FOR DA APPROVAL	A.V.	M.W.
A	20/06/17	ISSUED FOR DA APPROVAL	A.V.	A.T.
REV	DATE	DRAWING STATUS	DRN	APP
TITLE				

**SOIL & WATER MANAGEMENT
PLAN STAGE 2 SHEET 1**

DRAWING STATUS				SHEET SIZE
DRAFT COPY				A1
DRAWN	DESIGNED	APPROVED	SCALE	
M.Bector	A.Thompson	M.Watson	1:250	
PROJECT No.	DRAWING No.	REVISION		
13662	DA02	B		

NOT FOR CONSTRUCTION

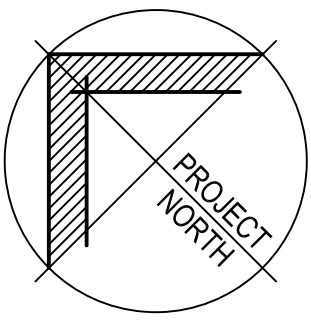

PROJECT
ABERDEEN VALLEY FAIR
ABERDEEN NSW 2336

CLIENT
ENEF INVESTMENTS PTY LTD

LEGEND

- EXISTING CONTOUR
- EXISTING SPOTLEVEL
- SEDIMENT CONTROL FENCE,
REFER TO DRAWING 13362-DA05 FOR DETAILS
- STABILISED SITE ACCESS,
REFER TO DRAWING 13362-DA05 FOR DETAILS
- SANDBAG SEDIMENT TRAP,
REFER TO DRAWING 13362-DA05 FOR DETAILS
- TEMPORARY STOCKPILE,
REFER TO DRAWING 13362-DA05 FOR DETAILS
- EXISTING ELECTRICITY LINE
- EXISTING SEWER LINE
- EXISTING TELSTRA LINE
- EXISTING WATER LINE
- BOUNDARY LINE
- EXISTING EASEMENT LINE
- EXISTING FENCE

NOTES

THE ARRANGEMENT OF SEDIMENT AND EROSION CONTROL MEASURES SHOWN ARE INDICATIVE ONLY AND RELATE TO A PARTICULAR STAGE OF THE CONSTRUCTION WORKS. IT SHALL BE THE CONTRACTOR'S RESPONSIBILITY TO DESIGN, CONSTRUCT AND MAINTAIN ANY ADDITIONAL MEASURES THAT MAY BE REQUIRED FOR THE CONTRACTOR'S CONSTRUCTION METHODOLOGIES, IN ORDER TO MEET ALL CONDITIONS AND REQUIREMENTS IMPOSED BY ANY STATUTORY AUTHORITY.

THE POSITION OF ALL EXISTING SERVICES SHOWN SHOULD BE REGARDED AS APPROXIMATE AND NOT NECESSARILY COMPREHENSIVE. IT IS THE CONTRACTOR'S RESPONSIBILITY TO DETERMINE THE EXACT LOCATIONS OF ALL SERVICES WHETHER SHOWN ON THE DRAWING OR NOT AND INFORM ALL RELEVANT AUTHORITIES PRIOR TO ANY EXCAVATION.

CONTRACTOR TO VERIFY SETOUT BEFORE COMMENCING EARTHWORKS. REFER ANY DISCREPANCIES TO ENGINEER.

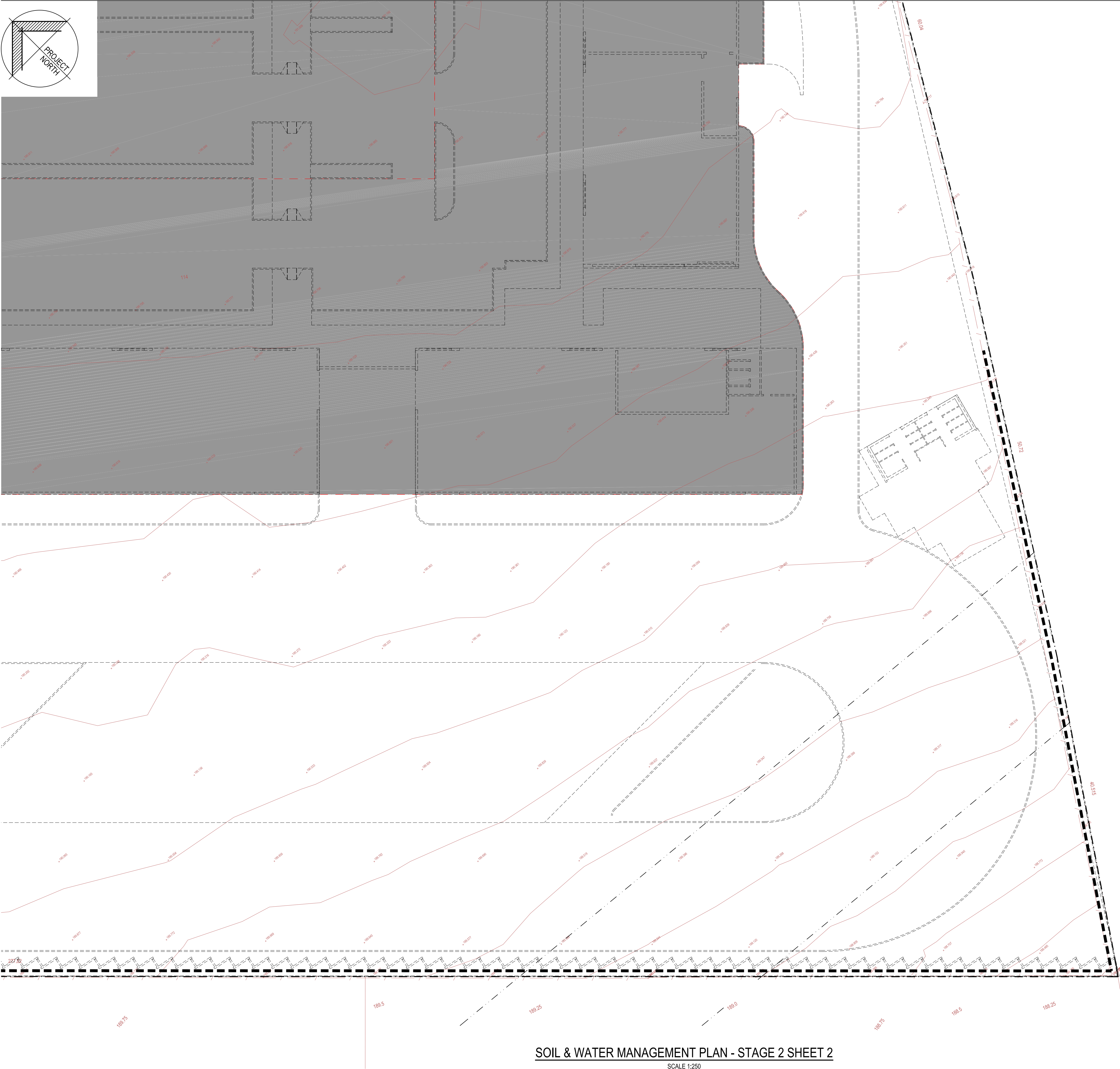

B	11/12/18	RE-ISSUED FOR DA APPROVAL	A.V.	M.W.
A	20/06/17	ISSUED FOR DA APPROVAL	A.V.	A.T.
REV	DATE	DRAWING STATUS	DRN	APP
TITLE				

**SOIL & WATER MANAGEMENT
PLAN STAGE 2 SHEET 2**

DRAWING STATUS			SHEET SIZE	
DRAFT COPY			A1	
DRAWN	DESIGNED	APPROVED	SCALE	
M.Bector	A.Thompson	M.Watson	1:250	
PROJECT No.		DRAWING No.	REVISION	
13662		DA03	B	

NOT FOR CONSTRUCTION

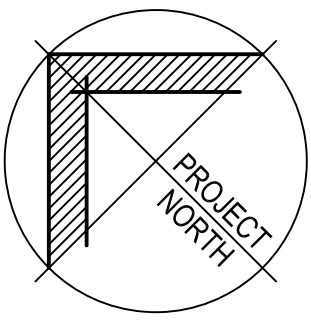

Sydney | Perth | **Newcastle** | Central Coast

5 Newton Street Broadmeadow NSW 2292
T: +61 2 49419900 E: mail@lindsaydynan.com.au

PROJECT
ABERDEEN VALLEY FAIR
ABERDEEN NSW 2336

CLIENT
ENEF INVESTMENTS PTY LTD

LEGEND

- EXISTING CONTOUR
- EXISTING SPOTLEVEL
- SEDIMENT CONTROL FENCE, REFER TO DRAWING 13362-DA05 FOR DETAILS
- STABILISED SITE ACCESS, REFER TO DRAWING 13362-DA05 FOR DETAILS
- SANDBAG SEDIMENT TRAP, REFER TO DRAWING 13362-DA05 FOR DETAILS
- TEMPORARY STOCKPILE, REFER TO DRAWING 13362-DA05 FOR DETAILS
- EXISTING ELECTRICITY LINE
- EXISTING SEWER LINE
- EXISTING TELSTRA LINE
- EXISTING WATER LINE
- BOUNDARY LINE
- EXISTING EASEMENT LINE
- EXISTING FENCE

NOTES

THE ARRANGEMENT OF SEDIMENT AND EROSION CONTROL MEASURES SHOWN ARE INDICATIVE ONLY AND RELATE TO A PARTICULAR STAGE OF THE CONSTRUCTION WORKS. IT SHALL BE THE CONTRACTOR'S RESPONSIBILITY TO DESIGN, CONSTRUCT AND MAINTAIN ANY ADDITIONAL MEASURES THAT MAY BE REQUIRED FOR THE CONTRACTOR'S CONSTRUCTION METHODOLOGIES, IN ORDER TO MEET ALL CONDITIONS AND REQUIREMENTS IMPOSED BY ANY STATUTORY AUTHORITY.

THE POSITION OF ALL EXISTING SERVICES SHOWN SHOULD BE REGARDED AS APPROXIMATE AND NOT NECESSARILY COMPREHENSIVE. IT IS THE CONTRACTOR'S RESPONSIBILITY TO DETERMINE THE EXACT LOCATIONS OF ALL SERVICES WHETHER SHOWN ON THE DRAWING OR NOT AND INFORM ALL RELEVANT AUTHORITIES PRIOR TO ANY EXCAVATION.

CONTRACTOR TO VERIFY SETOUT BEFORE COMMENCING EARTHWORKS. REFER ANY DISCREPANCIES TO ENGINEER.

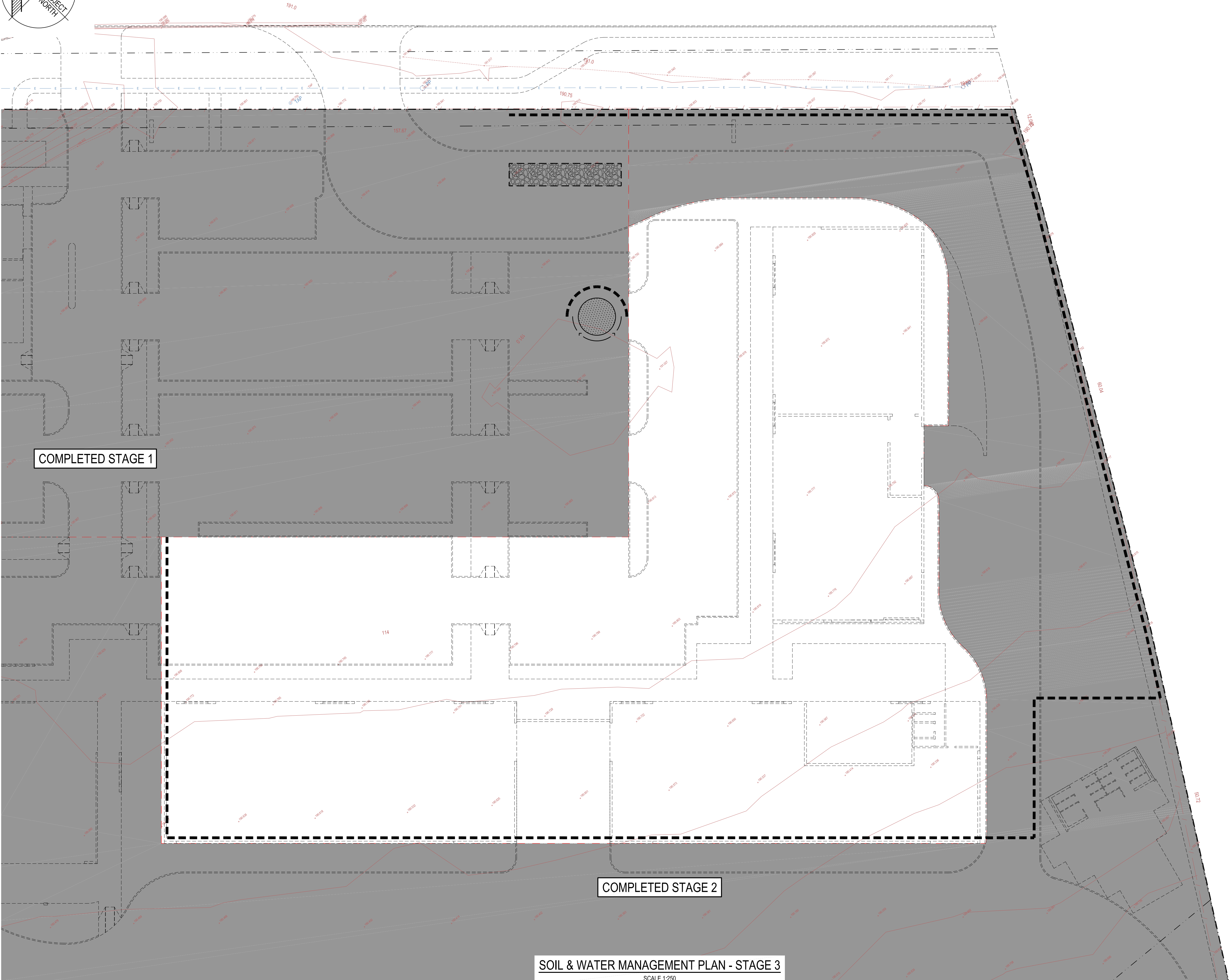

B	11/12/18	RE-ISSUED FOR DA APPROVAL	A.V.	M.W.
A	20/06/17	ISSUED FOR DA APPROVAL	A.V.	A.T.
REV	DATE	DRAWING STATUS	DRN	APP
TITLE				

**SOIL & WATER MANAGEMENT
PLAN STAGE 3**

DRAWING STATUS			SHEET SIZE	
DRAFT COPY			A1	
DRAWN	DESIGNED	APPROVED	SCALE	
M.Bector	A.Thompson	M.Watson	1:250	
PROJECT No.		DRAWING No.	REVISION	
13662		DA04	B	

NOT FOR CONSTRUCTION

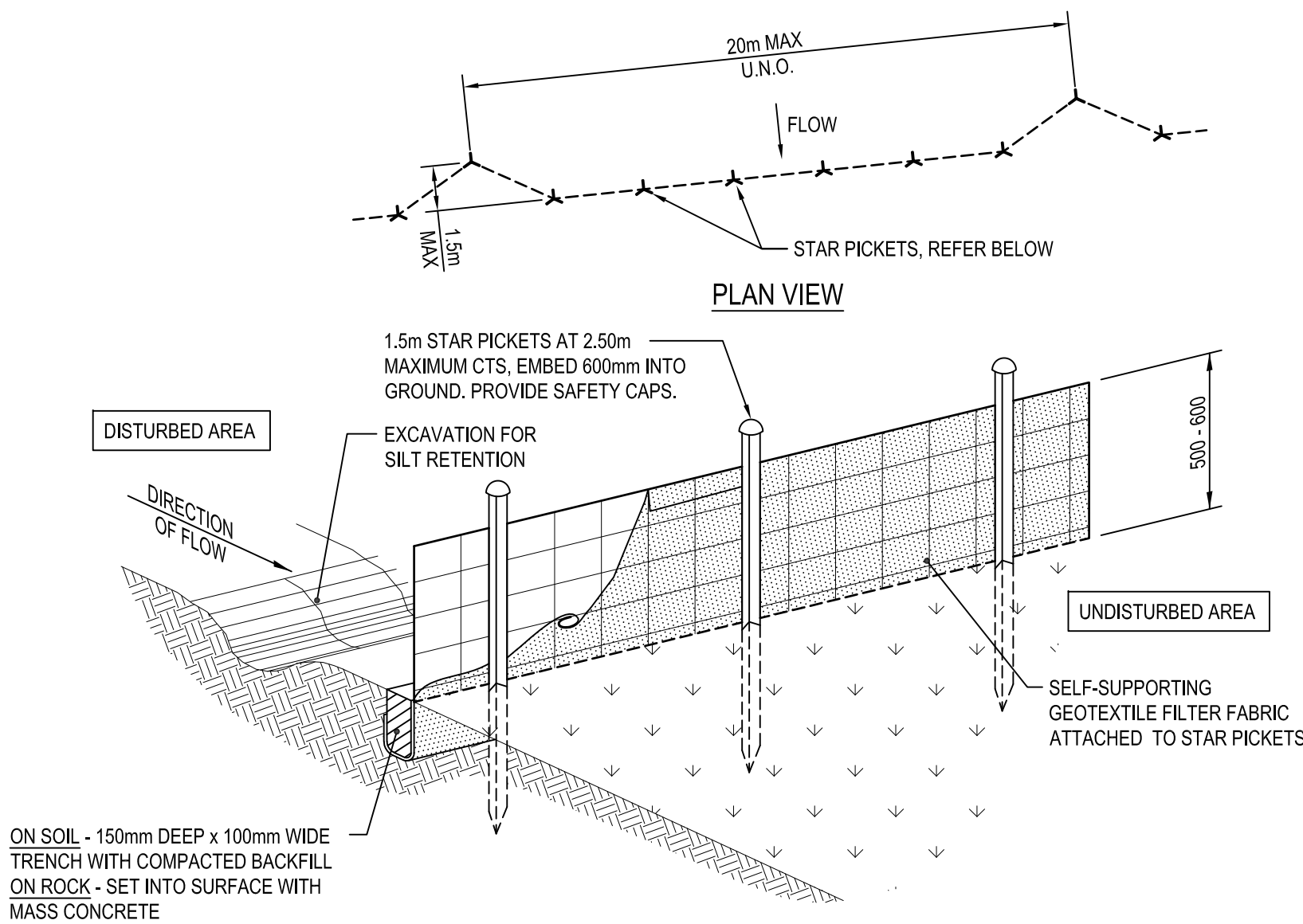

SEDIMENT CONTROL FENCE DETAIL

N.T.S.
IN ACCORDANCE WITH LANDCOM 'BLUE BOOK'
SD6-8 SEDIMENT FENCE

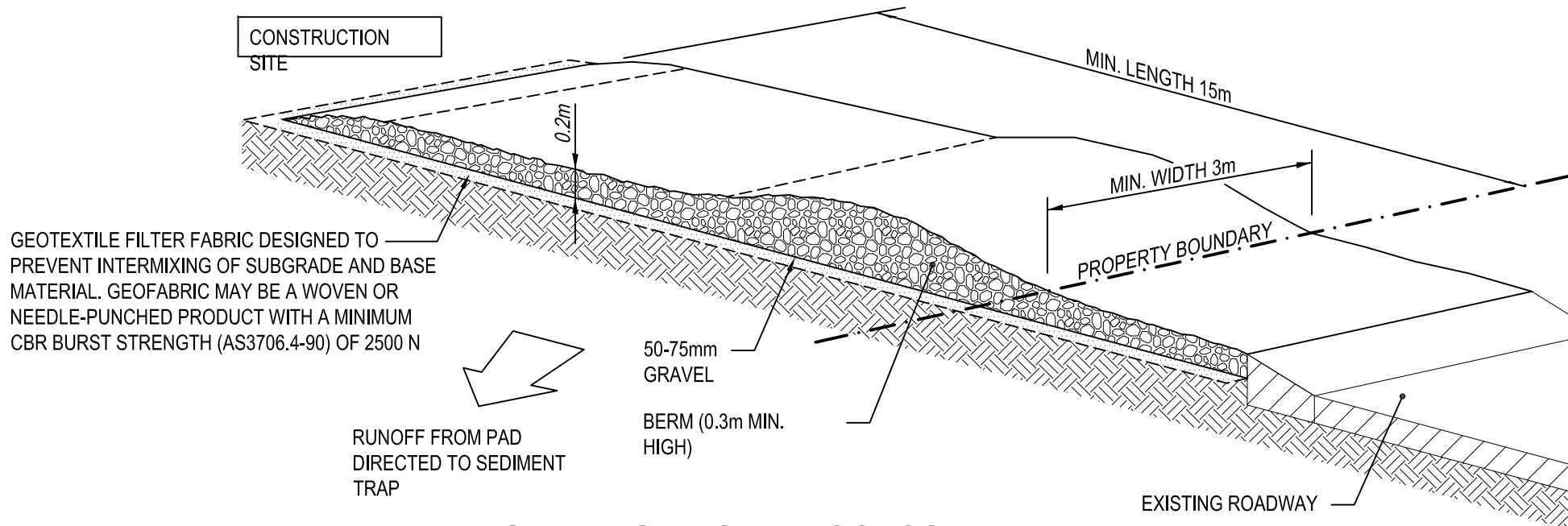

STABILISED SITE ACCESS DETAIL

N.T.S.
IN ACCORDANCE WITH LANDCOM 'BLUE BOOK'
SD6-14 STABILISED SITE ACCESS

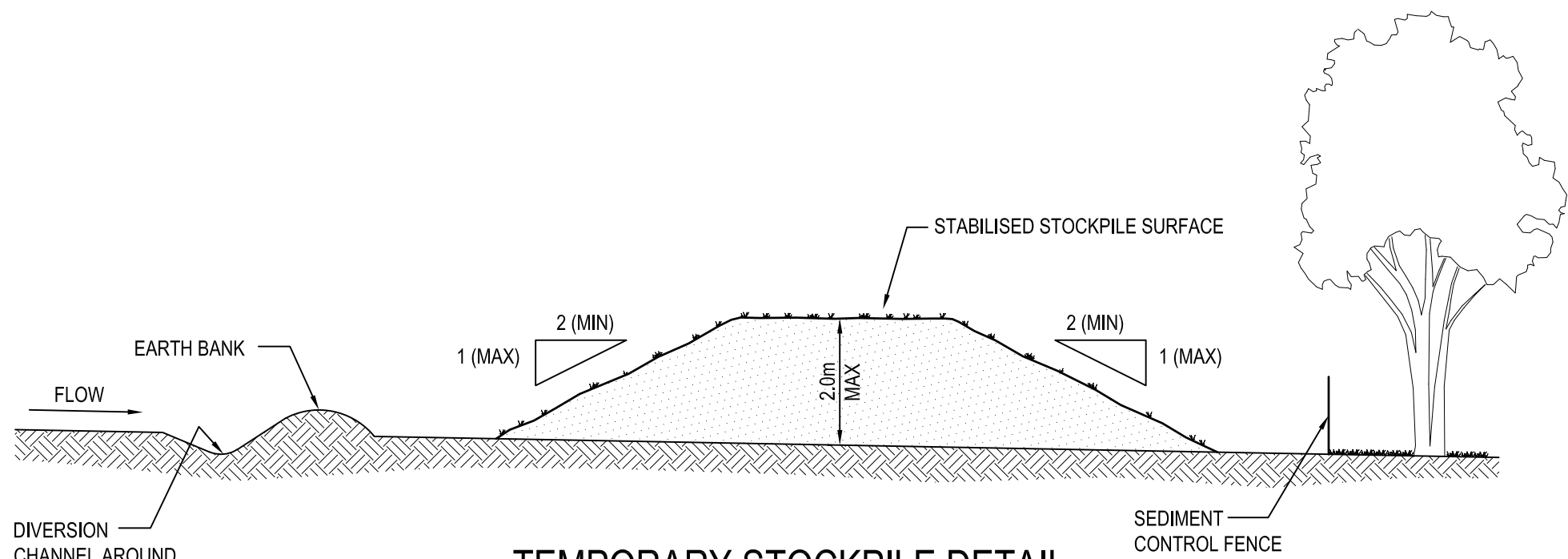

TEMPORARY STOCKPILE DETAIL

N.T.S.
IN ACCORDANCE WITH LANDCOM 'BLUE BOOK'
SD4-1 STOCKPILES

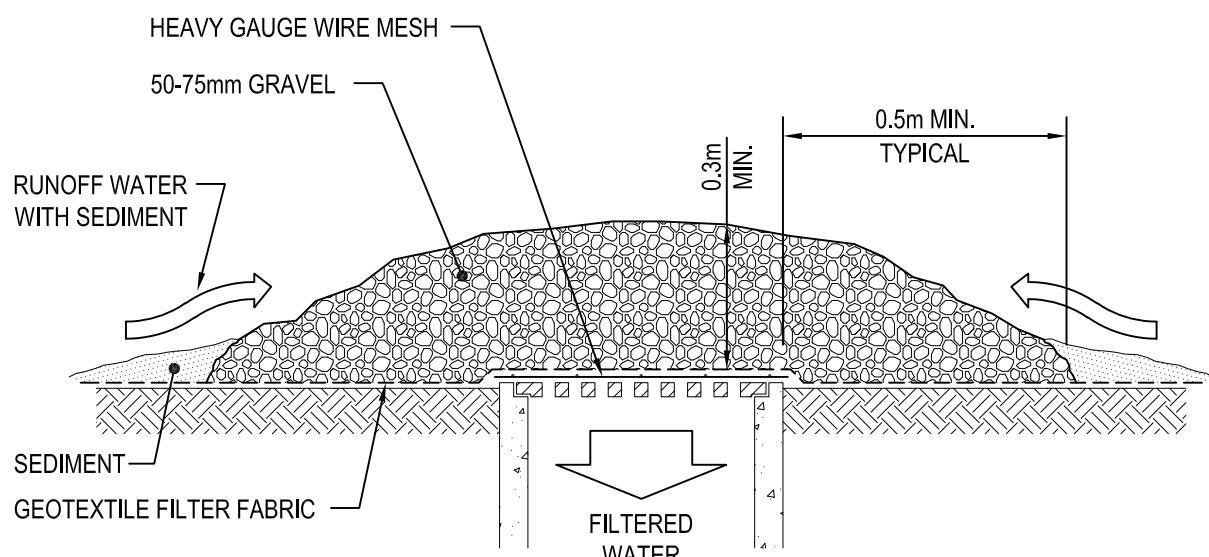

WIRE MESH AND GRAVEL DROP INLET PIT SEDIMENT TRAP DETAIL

N.T.S.

CONCEPT SUMMARY

- THE PROPOSED WORKS AT ABERDEEN VALLEY FAIR, ABERDEEN INVOLVE;
- DEMOLITION OF THE EXISTING SITE
 - CONSTRUCTION OF: A TWO STORY RETAIL AND COMMERCIAL BUILDING, FOUR RETAIL/BULKY GOODS BUILDINGS AND A SERVICE CENTRE/FAST FOOD RESTAURANT.
 - CONSTRUCTION OF REQUIRED CAR PARKS AND ROADS
 - ASSOCIATED LANDSCAPING.

SITE STORMWATER DESIGN PHILOSOPHY
THE STORMWATER SYSTEM WAS DESIGN IN ACCORDANCE WITH THE UPPER HUNTER SHIRES DCP AND GUIDELINES.
IT IS PROPOSED THAT ALL STORMWATER WILL BE DIRECTED TO A SPEL STORMCHAMBER OSD SYSTEM (OR SIMILAR PROPRIETARY DEVICE) IN THE SOUTHERN CORNER OF THE SITE. THE STORMWATER WILL THEN BE DISCHARGED VIA A LEVEL SPREADER OVER THE BOUNDARY IN THE SOUTHERN CORNER. THIS HAS BEEN DESIGNED TO CONTROL UP TO AND INCLUDING THE 100 YEAR ARI STORM EVENT
MUSIC MODELLING WAS USED TO ENSURE THAT THE UPPER HUNTER SHIRE COUNCIL'S WATER QUALITY REQUIREMENTS WERE MET. THESE REQUIRE THAT THERE IS A MAXIMUM EVENT MEAN CONCENTRATION OF 100mg/L SEDIMENT, 500ug/L HYDROCARBONS, 1000ug/L TOTAL NITROGEN, 15ug/L AMMONIA AND 100ug/L PHOSPHORUS. TO MEET THESE REQUIREMENTS WATER FROM THE SITE WAS DIRECTED TO A SERIES OF BIO-RETENTION BASINS, SPEL STORMWATER TREATMENT DEVICES AND A GRASS SWALE ALONG THE SOUTH WESTERN BOUNDARY.

SITE DATA
STAGE ONE:

TOTAL SITE AREA	= 10020 m ²
NEW DEVELOPMENT AREA	= 10020 m ²
NEW ROOF AREA	= 2624 m ²
NEW IMPERVIOUS AREA	= 5497 m ²
NEW PERVIOUS AREA	= 1899 m ²

STAGE TWO:

TOTAL SITE AREA	= 22392 m ²
NEW DEVELOPMENT AREA	= 22392 m ²
NEW ROOF AREA	= 2777 m ²
NEW IMPERVIOUS AREA	= 13593 m ²
NEW PERVIOUS AREA	= 6022 m ²

STAGE THREE:

TOTAL SITE AREA	= 9405 m ²
NEW DEVELOPMENT AREA	= 9405 m ²
NEW ROOF AREA	= 3357 m ²
NEW IMPERVIOUS AREA	= 4088 m ²
NEW PERVIOUS AREA	= 1960 m ²

OSD DATA:
DRAINS WAS USED TO CALCULATE THE REQUIRED OSD VOLUMES FOR EACH STAGE. THE FOLLOWING

STAGE 1	= 400 m ³
STAGE 2	= 900 m ³
STAGE 3	= 1200 m ³

SEDIMENT BASIN CALCULATION

THE SITE IS LOCATED IN THE DARTBROOK SOIL LANDSCAPE

- K-FACTOR OF 0.075*

THREE (3) CATCHMENT AREAS WERE CONSIDERED TO DETERMINE IF SEDIMENT BASINS WERE REQUIRED TO TREAT SEDIMENT LADEN RUN OFF FROM THE SITES. THE AMOUNT OF POTENTIAL SOIL LOSS WAS CALCULATED BY APPLYING THE REVISED UNIVERSAL EQUATION (RUSLE) METHOD:

SOIL LOSS = R K L LS P C

WHERE:

R= RAINFALL EROSMITY FACTOR = 164.74(1.1177)^S x S^{0.5644}

S = 2 YEAR, 6 HOUR STORM INTENSITY = 6.9mm/hr (ABERDEEN)

K = SOIL ERODIBILITY FACTOR = 0.075*

LS = SLOPE LENGTH/GRADIENT FACTOR AS SHOWN BELOW

P = EROSION CONTROL PRACTISE (P-FACTOR) = 1.3 (TYPICAL)

C = GROUND COVER (C-FACTOR) = 1 (TYPICAL FOR STRIPPED SITE)

STAGE	SLOPE LENGTH	SLOPE GRADE	CATCHMENT AREA	LS FACTOR	SOIL LOSS	SOIL LOSS	SOIL LOSS	SEDIMENT BASIN REQUIRED**
1	90	0.5%	1.06 ha	0.20	24.0 t/yrha	18.5 m ³ /yrha	19.5 m ³ /yr	NO
2	140	1.7%	2.25 ha	0.52	62.5 t/yrha	41.8 m ³ /yrha	108.0 m ³ /yr	NO
3	87	2.1%	0.95 ha	0.41	49.3 t/yrha	37.9 m ³ /yrha	36.0 m ³ /yr	NO

* ASSUMED K FACTOR. TO BE CONFIRMED BY GEOTEC AT CC STAGE

** SEDIEMNT BASINS NOT REQUIRED IF LESS THAN 150m³ OF SOIL LOSS PER YEAR

B	11/12/18	RE-ISSUED FOR DA APPROVAL	A.V.	M.W.
A	20/06/17	ISSUED FOR DA APPROVAL	A.V.	A.T.
REV	DATE	DRAWING STATUS	DRN	APP
TITLE				

SOIL & WATER MANAGEMENT DETAILS

DRAWING STATUS			SHEET SIZE	
DRAFT COPY			A1	
DRAWN	DESIGNED	APPROVED	SCALE	
M.Bector	A.Thompson	M.Watson	N.T.S.	
PROJECT No.		DRAWING No.	REVISION	

13662 DA05 B

NOT FOR CONSTRUCTION

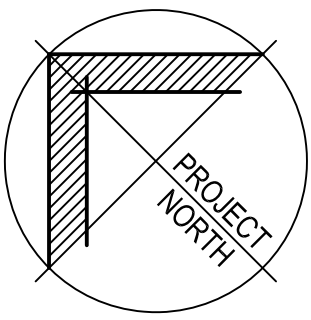

LEGEND

- 191.0 EXISTING CONTOUR
- 190.90 DESIGN CONTOUR
- EXISTING SPOTLEVEL
- DESIGN SPOTLEVEL
- NEW STORMWATER DRAINAGE PIT, INSTALLED TO MANUFACTURER'S SPECIFICATIONS
- NEW PVC STORMWATER DRAINAGE PIPE LAID AT 1.0% MIN FALL (U.N.G.) IN ACCORDANCE WITH MANUFACTURER'S SPECIFICATIONS
- DIRECTION OF SURFACE FALL
- OVERLAND FLOW PATH
- RW RETAINING WALL
- DD DENOTES DISH DRAIN
- 150K DENOTES 150 KERB
- FK DENOTES FLUSH KERB
- VC DENOTES VEHICULAR CROSSING
- EXISTING ELECTRICITY LINE
- EXISTING SEWER LINE
- EXISTING TELSTRA LINE
- EXISTING WATER LINE
- BOUNDARY LINE
- EXISTING EASEMENT LINE
- EXISTING FENCE

NOTES

- THE POSITION OF ALL EXISTING SERVICES SHOWN SHOULD BE REGARDED AS APPROXIMATE ONLY AND NOT NECESSARILY COMPREHENSIVE. IT IS THE CONTRACTOR'S RESPONSIBILITY TO DETERMINE THE EXACT SERVICE LOCATIONS AND INFORM ALL AUTHORITIES PRIOR TO ANY EXCAVATION.
- DURING CONSTRUCTION, THE STRUCTURE SHALL BE MAINTAINED IN A STABLE CONDITION AND NO PART OF THE STRUCTURE SHALL BE OVER-STRESSED. TEMPORARY STRUCTURES, FORMWORK, FALSEWORK, TEMPORARY BRACING, SHORING AND THE LIKE SHALL BE THE SOLE RESPONSIBILITY OF THE CONTRACTOR.
- ALL HANDRAILS, IF REQUIRED, ARE TO ARCHITECT'S LOCATION & DETAIL.
- BENCHMARKS TO BE PROVIDED PRIOR TO COMMENCEMENT OF CONSTRUCTION.
- EXISTING CONTOURS ARE SHOWN AT 0.25m INTERVALS. DESIGN CONTOURS ARE SHOWN AT 0.10m INTERVALS.
- TREATMENT OF ALL EXPOSED / DISTURBED AREAS TO LANDSCAPE ARCHITECT'S DETAILS.
- DETAIL OF LANDSCAPING IS TO TAKE INTO CONSIDERATION OVERLAND FLOW PATHS.
- ALL FENCES ARE TO BE DETAILED WITH 100mm GAP UNDER OR TO BE NON SOLID FENCES TO ALLOW WATER FLOW.
- WHERE SITE IS IN CUT ADJACENT TO SITE BOUNDARY, TOP OF RETAINING WALLS TO BE CONSTRUCTED FLUSH WITH EXISTING SURFACE OF NEIGHBOURING PROPERTIES TO AVOID IMPOUNDING WATER ON NEIGHBOURING PROPERTIES.

B	11/12/18	RE-ISSUED FOR DA APPROVAL	A.V.	M.W.
A	20/06/17	ISSUED FOR DA APPROVAL	A.V.	A.T.
REV	DATE	DRAWING STATUS	DRN	APP
TITLE				

STORMWATER DRAINAGE PLAN
STAGE 1

DRAWING STATUS			SHEET SIZE	
DRAFT COPY			A1	
DRAWN	DESIGNED	APPROVED	SCALE	
M.Bector	A.Thompson	M.Watson	1:250	
PROJECT No.	DRAWING No.		REVISION	

13662 **DA06** **B**

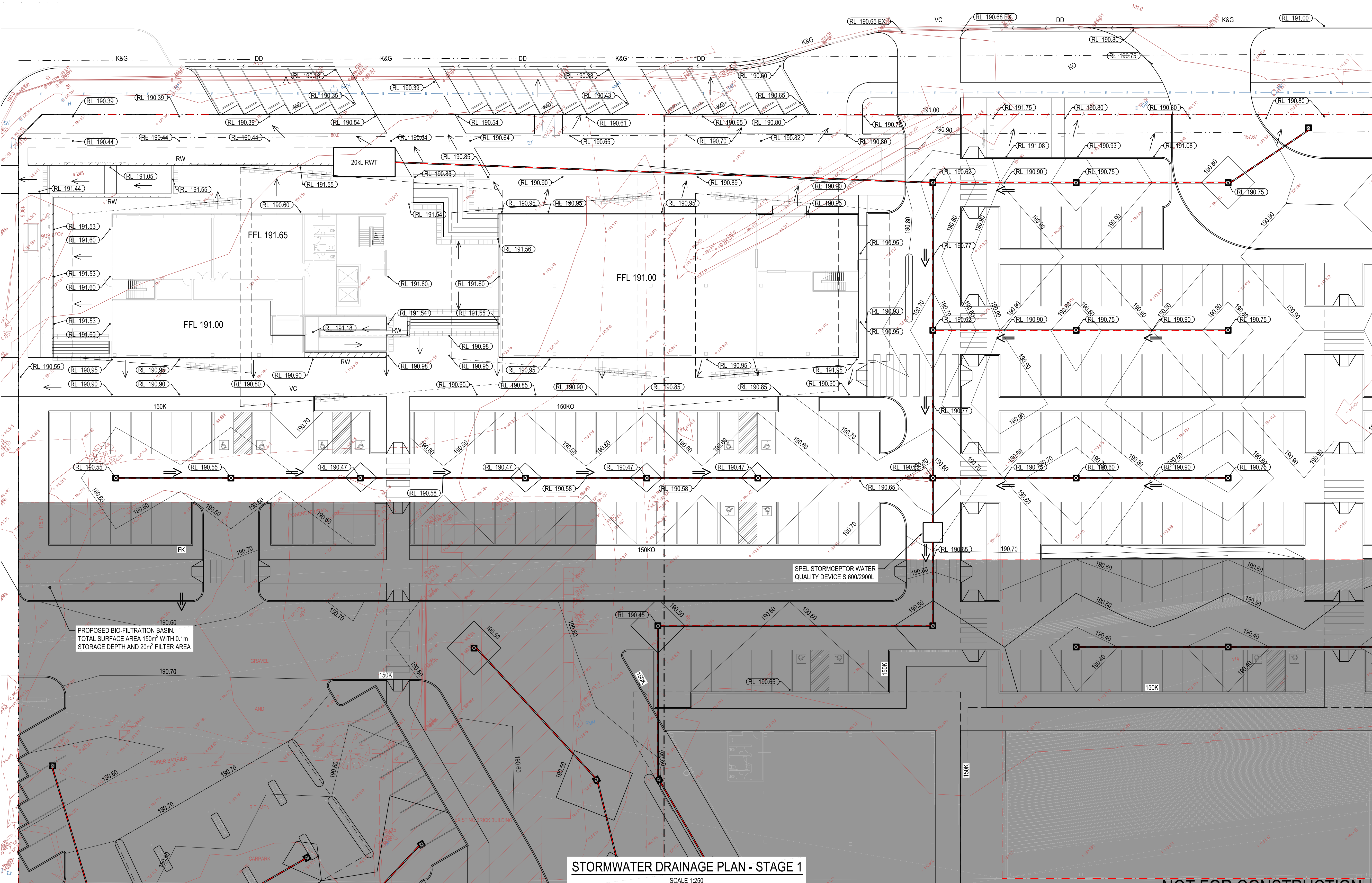

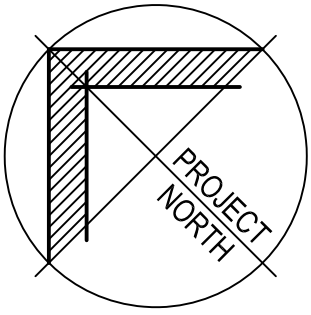

Sydney | Perth | Newcastle | Central Coast

5 Newton Street Broadmeadow NSW 2292
T: +61 2 49419900 E: mail@lindsaydynan.com.au

PROJECT
ABERDEEN VALLEY FAIR
ABERDEEN NSW 2336

CLIENT
ENEF INVESTMENTS PTY LTD

LEGEND

- EXISTING CONTOUR
- DESIGN CONTOUR
- EXISTING SPOTLEVEL
- DESIGN SPOTLEVEL
- NEW STORMWATER DRAINAGE PIT, INSTALLED TO MANUFACTURER'S SPECIFICATIONS
- NEW PVC STORMWATER DRAINAGE PIPE LAID AT 1.0% MIN FALL (U.N.O.) IN ACCORDANCE WITH MANUFACTURER'S SPECIFICATIONS
- DIRECTION OF SURFACE FALL
- OVERLAND FLOW PATH
- RETAINING WALL
- DENOTES DISH DRAIN
- DENOTES 150 KERB
- DENOTES FLUSH KERB
- DENOTES VEHICULAR CROSSING
- EXISTING ELECTRICITY LINE
- EXISTING SEWER LINE
- EXISTING TELSTRA LINE
- EXISTING WATER LINE
- BOUNDARY LINE
- EXISTING EASEMENT LINE
- EXISTING FENCE

NOTES

- THE POSITION OF ALL EXISTING SERVICES SHOWN SHOULD BE REGARDED AS APPROXIMATE ONLY AND NOT NECESSARILY COMPREHENSIVE. IT IS THE CONTRACTOR'S RESPONSIBILITY TO DETERMINE THE EXACT SERVICE LOCATIONS AND INFORM ALL AUTHORITIES PRIOR TO ANY EXCAVATION.
- DURING CONSTRUCTION, THE STRUCTURE SHALL BE MAINTAINED IN A STABLE CONDITION AND NO PART OF THE STRUCTURE SHALL BE OVER-STRESSED. TEMPORARY STRUCTURES, FORMWORK, FALSEWORK, TEMPORARY BRACING, SHORING AND THE LIKE SHALL BE THE SOLE RESPONSIBILITY OF THE CONTRACTOR.
- ALL HANDRAILS, IF REQUIRED, ARE TO ARCHITECT'S LOCATION & DETAIL.
- BENCHMARKS TO BE PROVIDED PRIOR TO COMMENCEMENT OF CONSTRUCTION.
- EXISTING CONTOURS ARE SHOWN AT 0.25m INTERVALS. DESIGN CONTOURS ARE SHOWN AT 0.10m INTERVALS.
- TREATMENT OF ALL EXPOSED / DISTURBED AREAS TO LANDSCAPE ARCHITECT'S DETAILS.
- DETAIL OF LANDSCAPING IS TO TAKE INTO CONSIDERATION OVERLAND FLOW PATHS.
- ALL FENCES ARE TO BE DETAILED WITH 100mm GAP UNDER OR TO BE NON SOLID FENCES TO ALLOW WATER FLOW.
- WHERE SITE IS IN CUT ADJACENT TO SITE BOUNDARY, TOP OF RETAINING WALLS TO BE CONSTRUCTED FLUSH WITH EXISTING SURFACE OF NEIGHBOURING PROPERTIES TO AVOID IMPOUNDING WATER ON NEIGHBOURING PROPERTIES.

B	11/12/18	RE-ISSUED FOR DA APPROVAL	A.V.	M.W.
A	20/06/17	ISSUED FOR DA APPROVAL	A.V.	A.T.
REV	DATE	DRAWING STATUS	DRN	APP
TITLE				

STORMWATER DRAINAGE PLAN STAGE 2 SHEET 1

DRAWING STATUS			SHEET SIZE	
DRAFT COPY			A1	
DRAWN	DESIGNED	APPROVED	SCALE	
M.Bector	A.Thompson	M.Watson	1:250	
PROJECT No.		DRAWING No.	REVISION	
13662		DA07	B	

NOT FOR CONSTRUCTION

STORMWATER DRAINAGE PLAN - STAGE 2 SHEET 1

SCALE 1:250

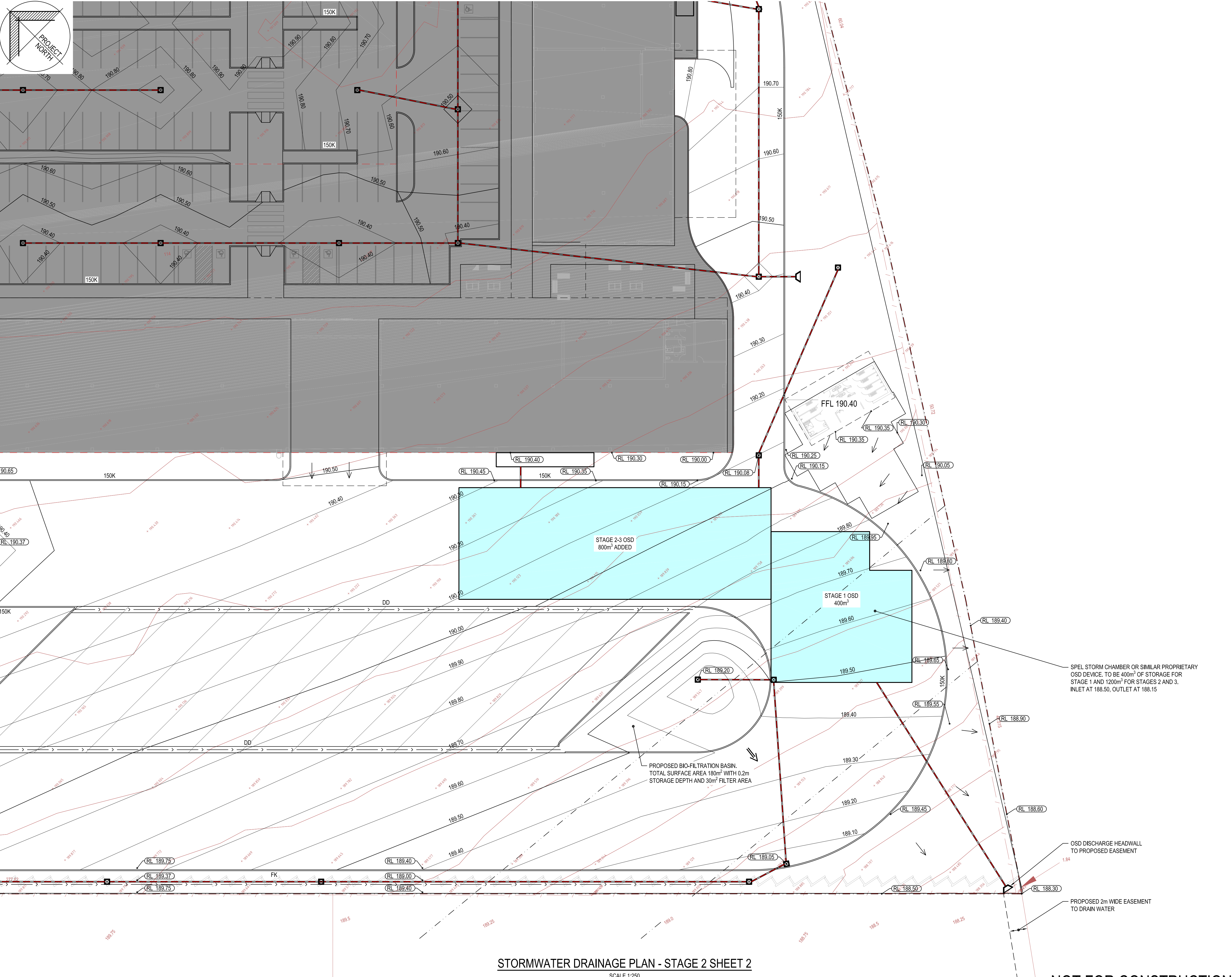
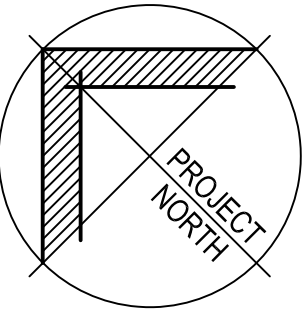

Sydney | Perth | Newcastle | Central Coast

5 Newton Street Broadmeadow NSW 2292
T: +61 2 49419900 E: mail@lindsaydynan.com.au

PROJECT
ABERDEEN VALLEY FAIR
ABERDEEN NSW 2336

CLIENT
ENEF INVESTMENTS PTY LTD

LEGEND

- EXISTING CONTOUR
- DESIGN CONTOUR
- EXISTING SPOTLEVEL
- DESIGN SPOTLEVEL
- NEW STORMWATER DRAINAGE PIT, INSTALLED TO MANUFACTURER'S SPECIFICATIONS
- NEW PVC STORMWATER DRAINAGE PIPE LAID AT 1.0% MIN FALL (U.N.G.) IN ACCORDANCE WITH MANUFACTURER'S SPECIFICATIONS
- DIRECTION OF SURFACE FALL
- OVERLAND FLOW PATH
- RETAINING WALL
- DENOTES DISH DRAIN
- DENOTES 150 KERB
- DENOTES FLUSH KERB
- DENOTES VEHICULAR CROSSING
- EXISTING ELECTRICITY LINE
- EXISTING SEWER LINE
- EXISTING TELSTRA LINE
- EXISTING WATER LINE
- BOUNDARY LINE
- EXISTING EASEMENT LINE
- EXISTING FENCE

NOTES

- THE POSITION OF ALL EXISTING SERVICES SHOWN SHOULD BE REGARDED AS APPROXIMATE ONLY AND NOT NECESSARILY COMPREHENSIVE. IT IS THE CONTRACTOR'S RESPONSIBILITY TO DETERMINE THE EXACT SERVICE LOCATIONS AND INFORM ALL AUTHORITIES PRIOR TO ANY EXCAVATION.
- DURING CONSTRUCTION, THE STRUCTURE SHALL BE MAINTAINED IN A STABLE CONDITION AND NO PART OF THE STRUCTURE SHALL BE OVER-STRESSED. TEMPORARY STRUCTURES, FORMWORK, FALSEWORK, TEMPORARY BRACING, SHORING AND THE LIKE SHALL BE THE SOLE RESPONSIBILITY OF THE CONTRACTOR.
- ALL HANDRAILS, IF REQUIRED, ARE TO ARCHITECT'S LOCATION & DETAIL.
- BENCHMARKS TO BE PROVIDED PRIOR TO COMMENCEMENT OF CONSTRUCTION.
- EXISTING CONTOURS ARE SHOWN AT 0.25m INTERVALS. DESIGN CONTOURS ARE SHOWN AT 0.10m INTERVALS.
- TREATMENT OF ALL EXPOSED / DISTURBED AREAS TO LANDSCAPE ARCHITECT'S DETAILS.
- DETAIL OF LANDSCAPING IS TO TAKE INTO CONSIDERATION OVERLAND FLOW PATHS.
- ALL FENCES ARE TO BE DETAILED WITH 100mm GAP UNDER OR TO BE NON SOLID FENCES TO ALLOW WATER FLOW.
- WHERE SITE IS IN CUT ADJACENT TO SITE BOUNDARY, TOP OF RETAINING WALLS TO BE CONSTRUCTED FLUSH WITH EXISTING SURFACE OF NEIGHBOURING PROPERTIES TO AVOID IMPOUNDING WATER ON NEIGHBOURING PROPERTIES.

B	11/12/18	RE-ISSUED FOR DA APPROVAL	A.V. M.W.
A	20/06/17	ISSUED FOR DA APPROVAL	A.V. A.T.
REV	DATE	DRAWING STATUS	DRN APP
TITLE			

STORMWATER DRAINAGE PLAN
STAGE 2 SHEET 2

DRAWING STATUS			SHEET SIZE	
DRAFT COPY			A1	
DRAWN	DESIGNED	APPROVED	SCALE	
M.Bector	A.Thompson	M.Watson	1:250	
PROJECT No.		DRAWING No.	REVISION	
13662		DA08	B	

NOT FOR CONSTRUCTION

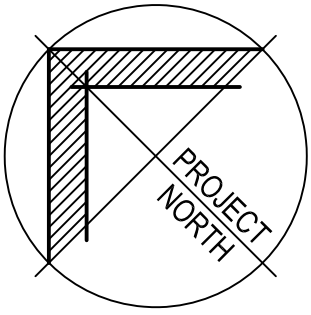

Sydney | Perth | **Newcastle** | Central Coast

5 Newton Street Broadmeadow NSW 2292
T: +61 2 49419900 E: mail@lindsaydynan.com.au

PROJECT
ABERDEEN VALLEY FAIR
ABERDEEN NSW 2336

CLIENT
ENEF INVESTMENTS PTY LTD

LEGEND

- EXISTING CONTOUR
- DESIGN CONTOUR
- EXISTING SPOTLEVEL
- DESIGN SPOTLEVEL
- NEW STORMWATER DRAINAGE PIT, INSTALLED TO MANUFACTURER'S SPECIFICATIONS
- NEW PVC STORMWATER DRAINAGE PIPE LAID AT 1.0% MIN FALL (U.N.G.) IN ACCORDANCE WITH MANUFACTURER'S SPECIFICATIONS
- DIRECTION OF SURFACE FALL
- OVERLAND FLOW PATH
- RETAINING WALL
- DENOTES DISH DRAIN
- DENOTES 150 KERB
- DENOTES FLUSH KERB
- DENOTES VEHICULAR CROSSING
- EXISTING ELECTRICITY LINE
- EXISTING SEWER LINE
- EXISTING TELSTRA LINE
- EXISTING WATER LINE
- BOUNDARY LINE
- EXISTING EASEMENT LINE
- EXISTING FENCE

NOTES

- THE POSITION OF ALL EXISTING SERVICES SHOWN SHOULD BE REGARDED AS APPROXIMATE ONLY AND NOT NECESSARILY COMPREHENSIVE. IT IS THE CONTRACTOR'S RESPONSIBILITY TO DETERMINE THE EXACT SERVICE LOCATIONS AND INFORM ALL AUTHORITIES PRIOR TO ANY EXCAVATION.
- DURING CONSTRUCTION, THE STRUCTURE SHALL BE MAINTAINED IN A STABLE CONDITION AND NO PART OF THE STRUCTURE SHALL BE OVER-STRESSED. TEMPORARY STRUCTURES, FORMWORK, FALSEWORK, TEMPORARY BRACING, SHORING AND THE LIKE SHALL BE THE SOLE RESPONSIBILITY OF THE CONTRACTOR.
- ALL HANDRAILS, IF REQUIRED, ARE TO ARCHITECT'S LOCATION & DETAIL.
- BENCHMARKS TO BE PROVIDED PRIOR TO COMMENCEMENT OF CONSTRUCTION.
- EXISTING CONTOURS ARE SHOWN AT 0.25m INTERVALS. DESIGN CONTOURS ARE SHOWN AT 0.10m INTERVALS.
- TREATMENT OF ALL EXPOSED / DISTURBED AREAS TO LANDSCAPE ARCHITECT'S DETAILS.
- DETAIL OF LANDSCAPING IS TO TAKE INTO CONSIDERATION OVERLAND FLOW PATHS.
- ALL FENCES ARE TO BE DETAILED WITH 100mm GAP UNDER OR TO BE NON SOLID FENCES TO ALLOW WATER FLOW.
- WHERE SITE IS IN CUT ADJACENT TO SITE BOUNDARY, TOP OF RETAINING WALLS TO BE CONSTRUCTED FLUSH WITH EXISTING SURFACE OF NEIGHBOURING PROPERTIES TO AVOID IMPOUNDING WATER ON NEIGHBOURING PROPERTIES.

B	11/12/18	RE-ISSUED FOR DA APPROVAL	A.V.	M.W.
A	20/06/17	ISSUED FOR DA APPROVAL	A.V.	A.T.
REV	DATE	DRAWING STATUS	DRN	APP
TITLE				

STORMWATER DRAINAGE PLAN
STAGE 3

DRAWING STATUS			SHEET SIZE	
DRAFT COPY			A1	
DRAWN	DESIGNED	APPROVED	SCALE	
M.Bector	A.Thompson	M.Watson	1:250	
PROJECT No.		DRAWING No.	REVISION	
13662		DA09	B	

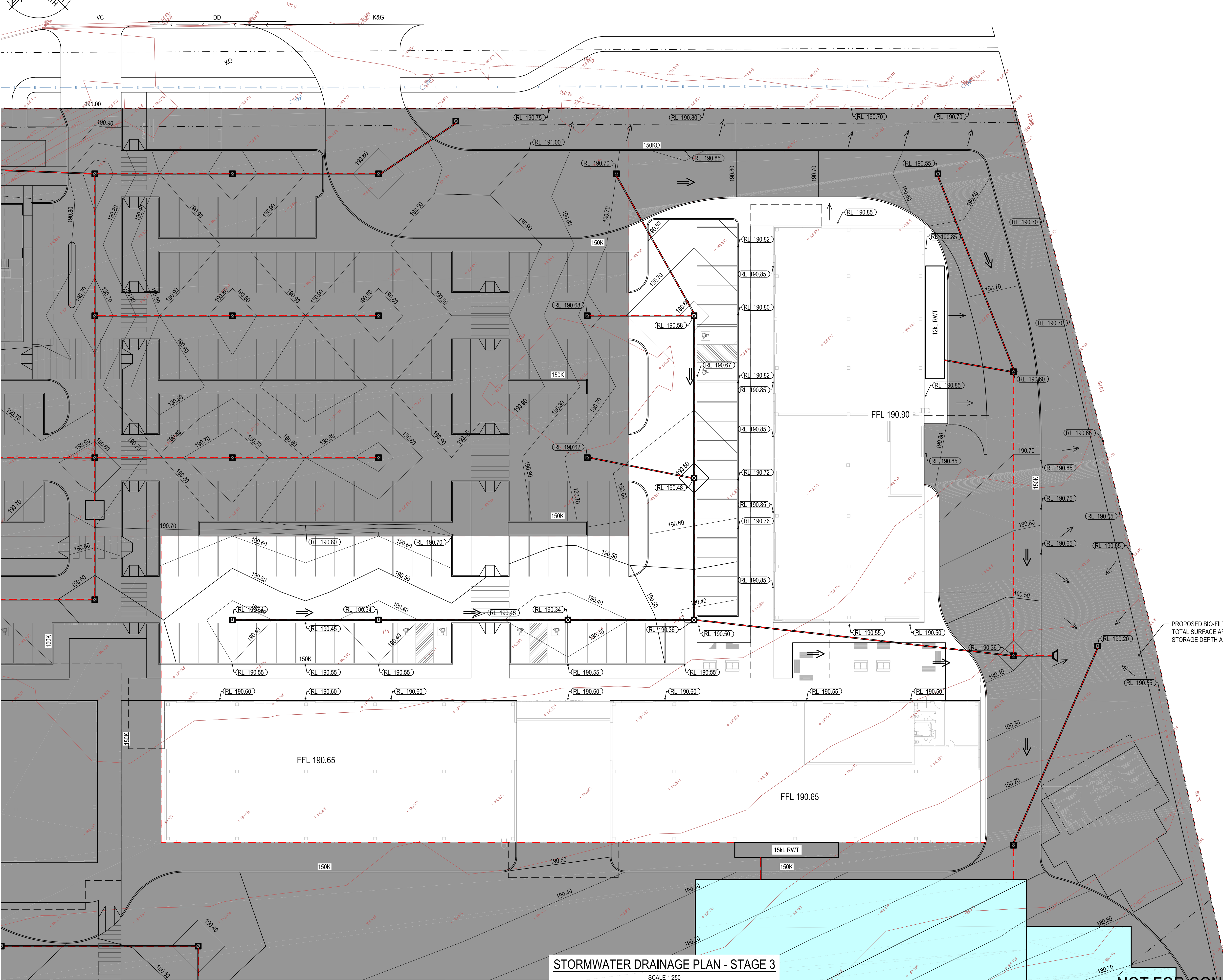

STORMWATER DRAINAGE PLAN - STAGE 3

SCALE 1:250

NOT FOR CONSTRUCTION